

FIRST

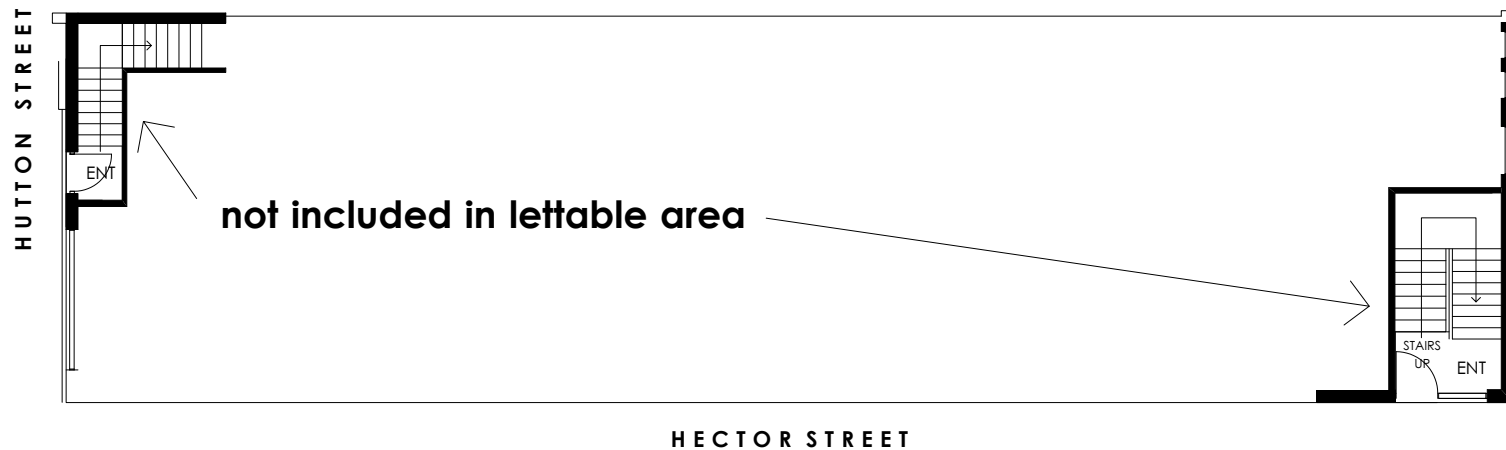

GROUND

**TENANCY 5B
44 Hutton Street, Osborne Park
OFFICE / SHOWROOM**

**AREA
GROUND**
HUTTON AND HECTOR STREET ENTRY'S
ARE NOT INCLUDED IN LETTABLE AREA
FIRST
TOTAL LETTABLE AREA (SHOWN SHADED) - 256.11m²



0 1 2 3 metres scale 1:100

PLAN IS APPROXIMATE AND REPRESENTATIONAL ONLY

WWW.TATEFLOORPLANS.COM.AU